



RespSense II™



Capnograph

MONITORING THE PATIENT



1. **Visually inspect** the monitor and sample line to make sure there are no visible signs of damage.
2. **Use a new sample line, Nafion® tubing (when used), moisture trap and filter for each patient.**
3. **Connect the sample line to the Luer lock connector on the moisture trap.**
4. **Apply the sample line to the patient.**
5. **Turn on the monitor** by pressing the ON/OFF button  until you see "Please Wait...".
6. **Verify all parameters are displayed** on the monitoring screen.
7. **Change the screen brightness** by pressing the  symbol in the lower left corner.
8. **Turn off the monitor** by pressing the ON/OFF button  for more than 3 seconds.



ALARMS

1. **At start-up, alarms are automatically silenced** for approximately 2 minutes unless the operator presses the Audio Pause button.
2. **Alarm Limit** – Default setting screen displays after the start-up screen. Choose alarm settings from factory defaults (pediatric or adult) or Last Used alarm settings.
3. **Change alarm settings** – Increase alarm limits with ; decrease with .
4.  **Audio Pause button** – Pause/activate the audible alarm. If paused, it will remain silent for approximately 2 minutes unless the button is pressed again or a new audible alarm occurs.
5. **Change alarm volume** by pressing the symbol in the lower right corner.

POWER AND BATTERY

1. **Plug the RespSense power supply into the monitor or operate on battery power.**
2. **The green charge indicator  comes on as soon as the monitor is connected to the power outlet.** It indicates the battery is charging.
3.  **Indicates remaining battery capacity.**
4. **When fully charged, the RespSense can run on battery for approximately 5 hours.**

REPLACING THE MOISTURE TRAP AND FILTER

1. **Place the filter in the moisture trap** so the silicone gasket faces up and hydrophobic material fits inside the moisture trap opening (A).
2. **Using the guide marks on the back of the monitor, align the groove at the top of the moisture trap with the ridge at the top of the trap housing on the monitor (B).**
3. **The trap is tilted in top first, then bottom.** Press the moisture trap into position using the tab (C). There should be a tactile click and the moisture trap should be flush with the side and back of the monitor.
4. **To remove the moisture trap** and replace the filter, use the tab to pull the moisture trap away from the monitor. Remove the filter from the moisture trap. If the filter is not in the moisture trap, check to see if it is still attached to the monitor.

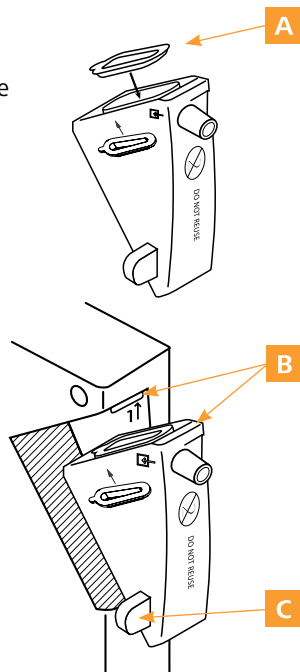

THIS GUIDE IS FOR REFERENCE ONLY. Refer to the Operator's Manual for complete information, warnings, cautions and specifications for the product you are using.

Visit nonin.com for more information and video tutorials.

R_x only



nonin.com

Nonin Medical, Inc.
 13700 1st Avenue North
 Plymouth, MN 55441-5443 • USA
Tel: +1.763.553.9968
 1.800.356.8874
Fax: +1.763.577.5521
E-mail: info@nonin.com

Nonin Medical B.V.
 Prins Hendriklaan 26
 1075 BD Amsterdam • Netherlands
Tel: +31 (0)13-79 99 040
Fax: +31 (0)13-79 99 042
E-mail: infointl@nonin.com